

Excess 14
"Arabella"

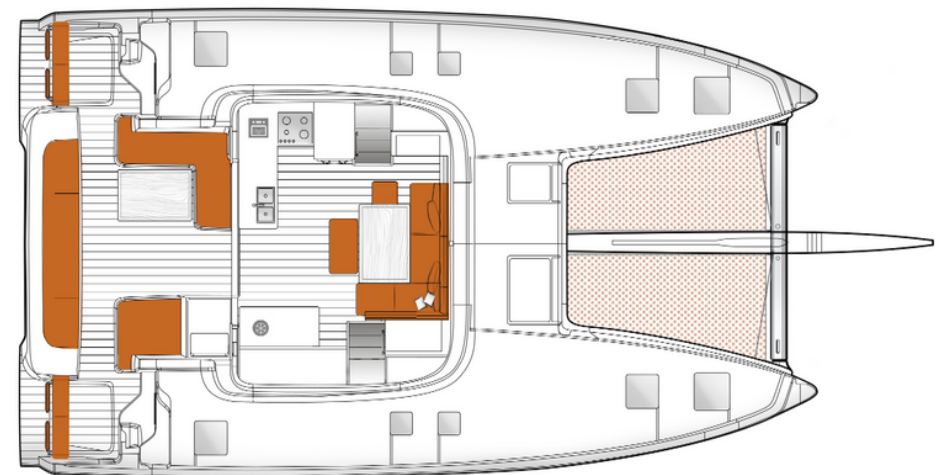

Specifications

Length:	15.99 m/52' 5"
Beam:	7.87 m/25' 9"
Draft:	1.48 m/4' 10"
Engine:	2x 57 HP – YANMAR 4JH57
Cabins:	4+2
Year of construction:	2024
Fuel tank:	2 x 200 l / 2 x 53 US gal
Water tank:	300 l / 79 US gal

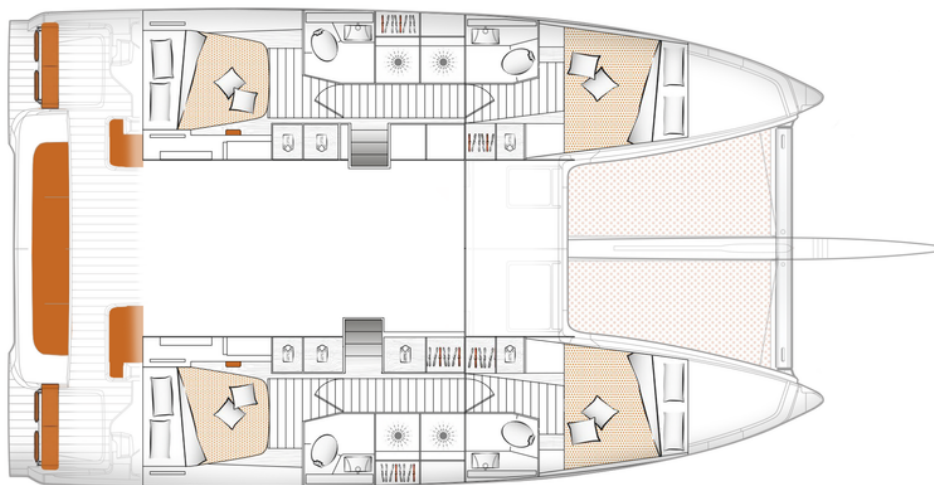



Equipment

Sail Away Orange

Electric winches

Code 0

2 Garmin GPSMAP 12" display

Garmin Fantom Radar 18"

VHF Garmin Single Handset

AIS 800 Garmin transceiver

Remote control for anchor winch

Cockpit fridge 75 l

Additional fridge/freezer drawer in the salon 155 l

Port and starboard biminis with windows

Electric toilets on sea water

Fusion sound package in the saloon and cockpit

Stand-up paddle board

Highlights

Inverter 2 kVA (12 V/220 V 50 HZ)

Generator Onan 7.5 kVA (220 V/50 HZ)

Air conditioner

Tender with 20 HP



