



Excess 11

TECHNICAL SPECIFICATIONS



Length overall	11.42 m 37'6"
Hull length	11.33m 37'2"
Beam	6.59m 21'7"
Mast clearance	17.27m 56'8"
Draft	1.15m 3'9"
Light displacement [EEC]	9,000 kg 19,845 lbs



Square top mainsail	55m² 592 sq ft
Overlapping genoa	32.5m² 350 sq ft
Code 0 [option]	54m² 581 sq ft
Upwind sail area	90m² 969 sq ft
Upwind sail area [Pulse Line]	95.5m² 1028 sq ft



Fresh water capacity	300 L 79 US Gal
Black water capacity	160 L 42 US Gal
Fuel capacity	2 x 200 L 2 x 53 US Gal
Engines	2 x 29 HP
Berths	6 to 12
EC Certification	A: 8 - B: 12 - C: 16 - D: 20

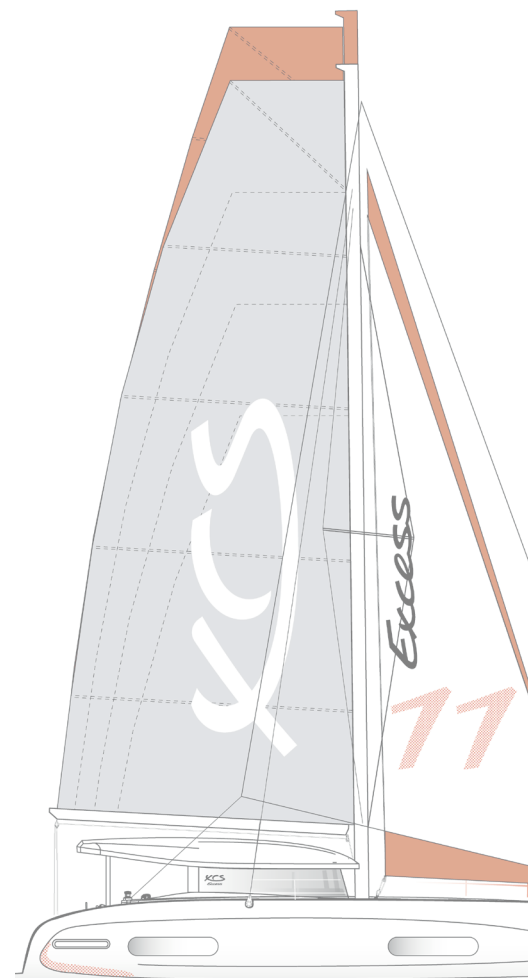

EXTERIOR

- Vacuum infused hull and nacelle
- Deck and roof : injection
- Polyester and high quality anti-osmotic resin
- Balsa core hull
- Grey gelcoat hull [Ral 7004]

SAILS

- 1 square top mainsail in Dacron® [color:white] with battens, horizontal cut
- 1 overlapping genoa in Dacron® [color: white] on furler, horizontal cut, with orange UV cover

RIGGING [Standing & Running]

- Anodized aluminium mast
- 2 spreaders set
- Deck light and steaming light on mast
- Anodized aluminum boom
- Anodized aluminum crossbeam with fixing point for the genoa furler and the davit
- Coated shrouds
- Forestay with furler for overlapping genoa
- Adjustable lazy-jack
- 2 shroud chainplates
- 1 forestay chainplate on transversal beam
- Double braided mainsail halyard - polyester [Dyneema® core]
- Double braided genoa halyard - polyester [Dyneema® core]
- 2 mainsail sheets, pre-stretched - polyester
- 2 reef lines, pre-stretched - polyester [reef 1 dyneema core]
- 2 genoa sheets, pre-stretched - polyester
- 1 genoa furler line, pre-stretched - polyester

DECK HARDWARE [Winches & Gear]

- 1 manual winch size 40.2 STA [starboard]
- Main sail clew line lashing
- 1 block + clutch on deck for furling genoa maneuver [starboard]
- 2 genoa sheet on track with friction rings

MOORING

- Composite longitudinal crossbeam with integrated chain run and 1 mooring cleat
- Quick 1.000 W electrical windlass [10mm chain]
- 8 mooring cleats

DECK EQUIPMENT

- Main deck in white composite
- 2 Flush deck hatches T60 to access bow lockers
- 2 Flush deck hatches T10 with vent
- 4 Flush deck hatches T44 with vent
- Sliding door - 2 leaves
- 2 escape hatches under the stairs
- 1 GRP deck hatch for access to gas locker under cockpit seat
- 10 stainless steel stanchions - 600 mm
- Double stainless steel lifelines
- Stainless steel handrail on roof

AFT COCKPIT

- L-shaped bench on starboard
- GRP cockpit table
- Daybed on port
- Seat on aft beam with large storage locker

HELM STATIONS

- Main helm station on starboard:
 - Leather covered steering wheel and brake [700 mm]
 - 2 engine panels
 - Mechanical engine throttles
 - Lines storage
- Secondary helm station on port:
 - Leather covered steering wheel [700 mm]

FORWARD COCKPIT

- Trampoline with grey nylon thread
- Large sun pads area
- 2 GRP hatches for storage and technical access

TRANSOMS

- Stainless steel swim ladder [port]
- Hot|cold fresh water deck shower [port]

INTERIOR

- Alpi Honey Teak plywood [UV varnish]
- Plywood floor: Sand

SALON

- L-shaped sofa [storage under seats]
- Wooden high table
- Chart table with storage and seat

GALLEY

- Laminated wood countertop [Arpa - Grigio Sasso]
- Starboard:
 - 1 Stainless steel sink
 - 2-burner gas stove
 - Built-in gas oven
 - Trash bin
 - Stainless steel fridge - 130 L 12 V
 - Various storage
- Port:
 - Various storage

OWNER'S SUITE

- Independent access directly from salon
- Sliding door with storage
- Bed [2.00 x 2.00 m]
- 2 reading lights
- Storage underneath mattress [easy opening with actuator]
- Desk with opening flap
- 1 stool
- Hanging closets with shelves
- Storage | Fabric folder in bulkhead [x2]
- Panoramic hull window with integrated opening porthole
- Adjoining bathroom with direct access
- GRP countertop
- GRP sink with hot|cold water tap
- Various storage units lockers
- Hanging closet with shelves
- Separate shower with Plexiglas door
- Manual sea water WC

FORWARD CABINS

- Bed [2.05 x 1.80 m | 1.40 m]
- 2 reading lights
- Hanging closet and storage
- Closet with shelves and storage
- Storage underneath mattress [easy opening with actuator]
- Storage | Fabric folder in bulkhead [x1]
- Panoramic hull window with integrated opening porthole

AFT CABINS

- Bed [2.05 x 1.60 m]
- 2 reading lights
- Storage underneath mattress [easy opening with actuator]
- Storage | Fabric folder in bulkhead [x1]
- Panoramic hull window with integrated opening porthole

HEADS

- Access from companionway through sliding wooden door
- GRP countertop
- GRP sink with hot|cold water tap
- Overhead lockers
- Separate shower with Plexiglas door
- Manual sea water WC

SYSTEMS

ENGINE

- 2 diesel engines YANMAR 3YM30 29HP saildrive
- 2-blades fixed propeller [16"x14"]
- Engine compartment air extractor - 12 V
- 2 GRP hatches for engine compartment access

NAVIGATION

- Textile steering system
- Link rod between the rudders
- Rudder with stainless steel shaft
- Stainless steel emergency tiller

FUEL SYSTEM

- Rotomould fresh water tank [2 x 200 L | 2 x 53 US gal]
- Deck fuel fillers on aft beam [starboard and port]
- Fuel shut off valves under berths in aft cabins

WATER SYSTEMS

- Rotomould fresh water tank [300 L | 79 US gal]
- Water pump
- Water heater 230 V [25 L | 7 US gal]
- Fuel shut off valves under berths in aft cabins
- Shower pump with automatic drain
- Black water tank [80 L | 21 US gal] for each head
- 1 manual bilge pump per hull
- 1 automatic bilge pump per hull, with alarm

ELECTRICAL SYSTEM

- 2 alternators 12 V - 125 A
- 2 start batteries 12 V - 50 A [AGM]
- 2 service batteries 12 V - 140 A [AGM]
- 40 A charger
- Service batteries breakers in port engine compartment
- Engine battery breakers in port & starboard engine compartments
- Charge divider
- Main DC panel at chart table - 12 V
- USB socket integrated on main DC panel - 12 V
- USB socket at chart table - 12 V
- Monitoring tank levels - 2.4' screen
- Interior lighting LED - 12 V
- Navigation lights LED

SAFETY

- Liferaft storage under aft beam
- Access to extinguisher nozzle port for engine compartment

SAIL AWAY [Option]

- Electric Pack
 - 2 additional service batteries 12 V - 140 A [AGM] [Tot: 4x 140 A AGM]
 - 40 A charger
 - Battery controller
 - Shore power - 32 A
 - 230 V outlet and double USB sockets in salon and cabins
 - USB sockets at helm station [x2] - 12 V

- Garmin electronics
 - 7" multifunctional display [starboard console]
 - Tablet support [portside console]
 - VHF single handset | portative compass [chart table]
 - Autopilot with electronic compass
 - Speed | Depth | Temp.Smart Transducer
 - Wind transducer
- Double helm foldable seat on starboard
- Roof forward portholes [x2]
- Deck light

ROOF

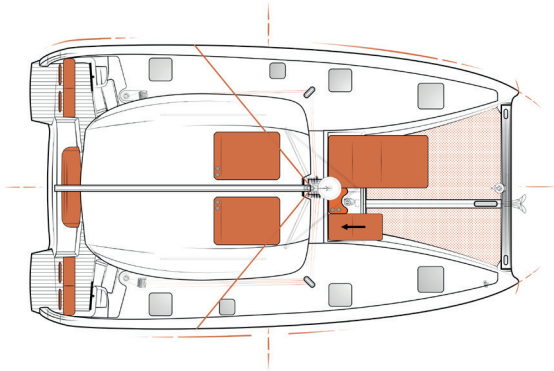

-  **NAVAL ARCHITECT**
VPLP design
-  **EXTERIOR DESIGN**
Patrick Le Quément
-  **INTERIOR DESIGN**
Nauta Design

DECK - COCKPIT

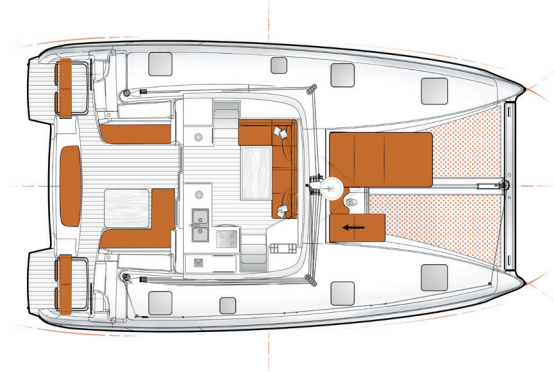

3 CABINS - 2 HEADS



4 CABINS - 2 HEADS

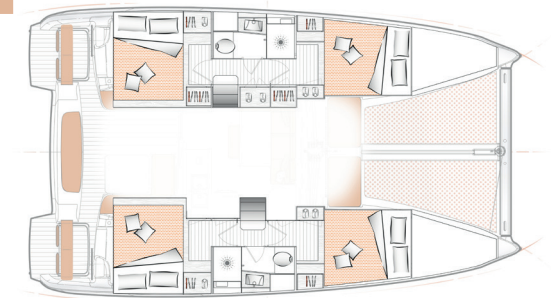

LOA: 11.42 m | 37'6"
BMAX: 6.59 m | 21'7"



6 - 12



2 x 29 HP



2 x 200 L | 2 x 53 US gal



300 L | 79 US gal
[Opt: +300 L | +79 US gal]



160 L | 42 US gal